

Installation Guide

Revision History:

Rev. 1.0: Initial release

Accessory Ordering part no.: VIO900000082

1 Compatible VIVOTEK Cameras

Compatible cameras/brackets

A: IT9360-H, IT9380-H
B: IB9360-H, IB9368-HT, IB9380-H, IB9383 series, IB9388-HT, IB9389-V2 series, IB9389-V3 series, IB9399 series

Mounting Dimensions

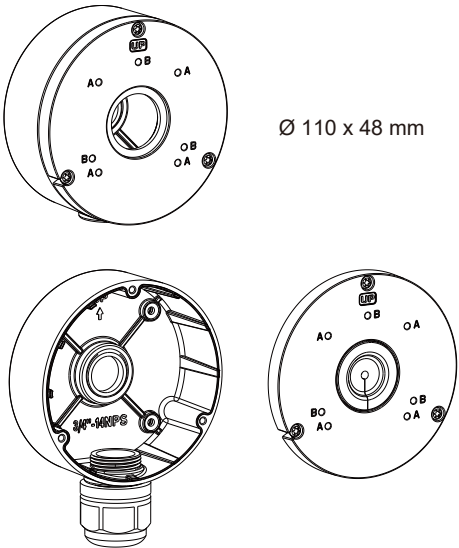

Package Contents

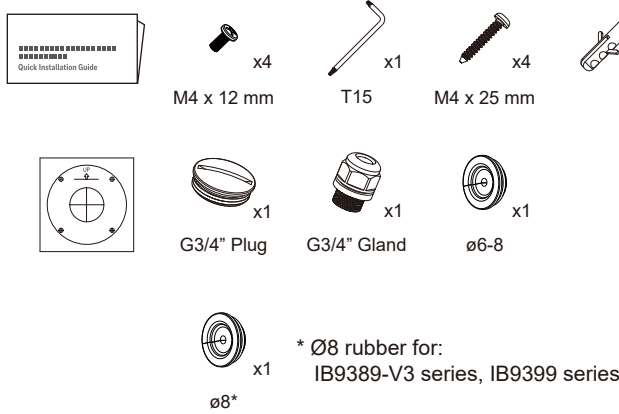

3 Attach the included alignment sticker to a preferred position. Drill holes on the wall and install the junction box. If space behind the wall allows, you may also pass cables through the wall.

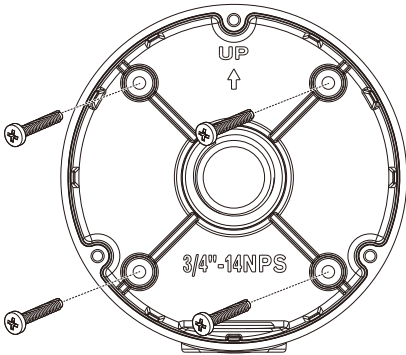

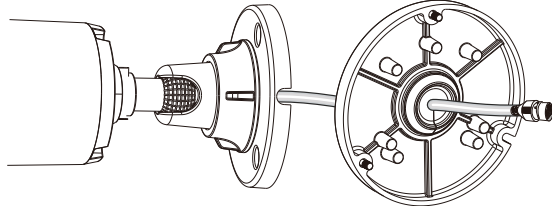

4 Pass the camera's Ethernet cable through the center hole of the box and the rubber seal.

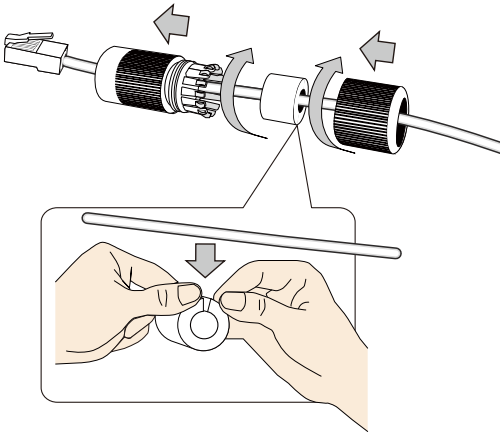

5 Install the waterproof components of the cable gland to your Ethernet cable following the QIG of your camera. The cable gland will be placed within the protection of the box.



6 Make sure the rubber seal is properly installed to the center hole. The outer rim of the seal must be through and cover the edge of the hole.
Choose the appropriate rubber seal:  Ø8 x1 based on diameter of your cable  Ø6-8 x1

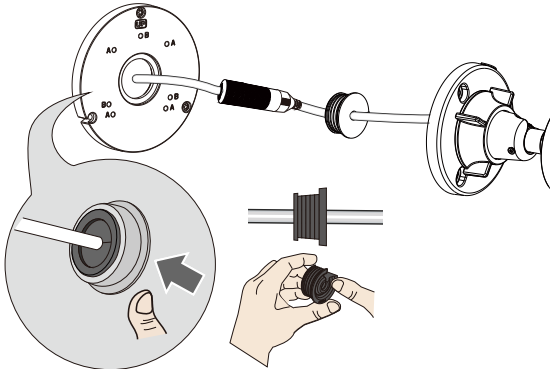

Installation

Remove the top cover

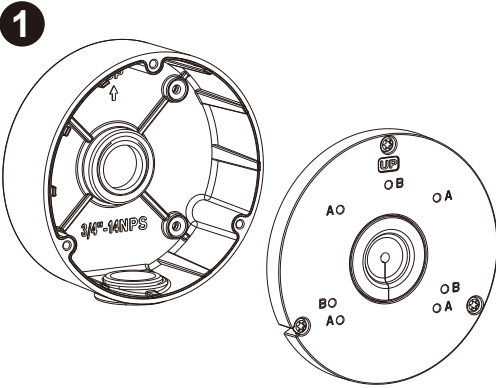

A 3/4" conduit is required for routing the cables with waterproof connection.

2

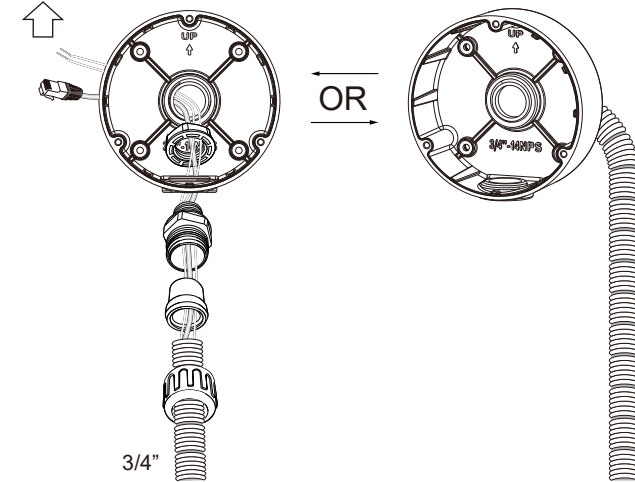
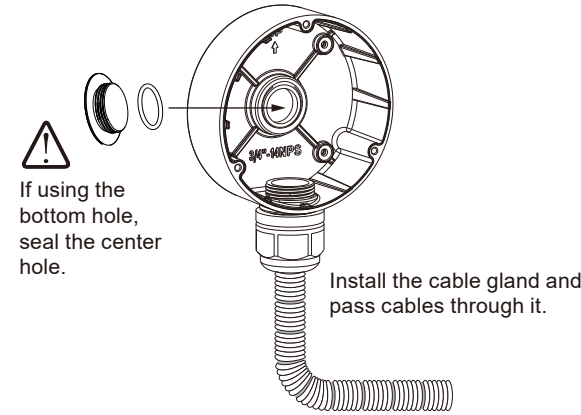

7 **A:** IT9360-H, IT9380-H
B: IB9360-H, IB9368-HT, IB9380-H, IB9383 series, IB9388-HT, IB9389-V2 series, IB9389-V3 series, IB9399 series

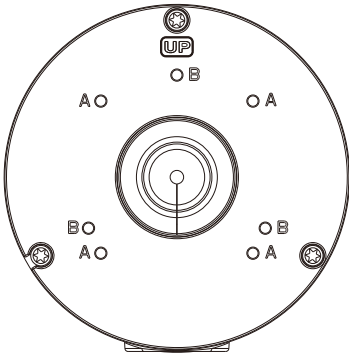

8 Secure the top cover by fastening 3 hex socket screws.

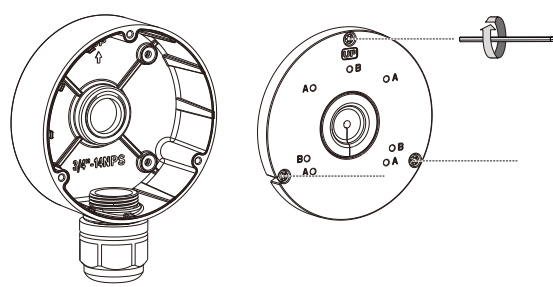

9 Install the camera using the corresponding mounting holes with the included hex socket screws.

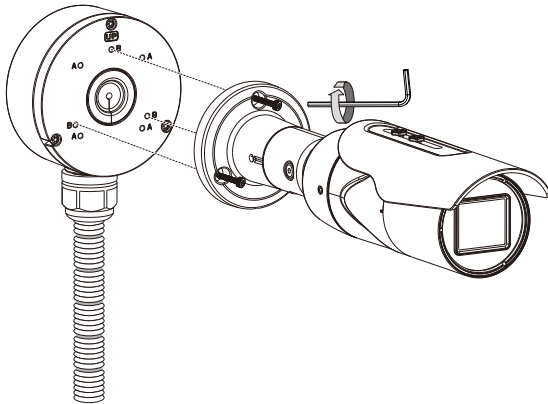

10 Open a live view console and adjust the shooting direction. Refer to camera QIG for more information.

