

**AM-71H\_V2 Conduit Box**

**Installation Guide**

**Revision History:**

Rev. 1.0: Initial release

Accessory Ordering part no.: VIO900000083

**Compatible VIVOTEK Cameras**

Compatible cameras/brackets	
A	FD9368/FD9383-HTV/FD9388/FD9389-V2/FD9389-V3/FD9399
B	IT9383/IT9388
C	FD9360/FD9380/FD9383-HV
D	IT9389-V3/IT9399/FE9380/FE9382-V2/FE9391-V2/FE9191-V2
E	TB9332-E
F	TB9333-E/TT9333-E

**Mounting Dimensions**

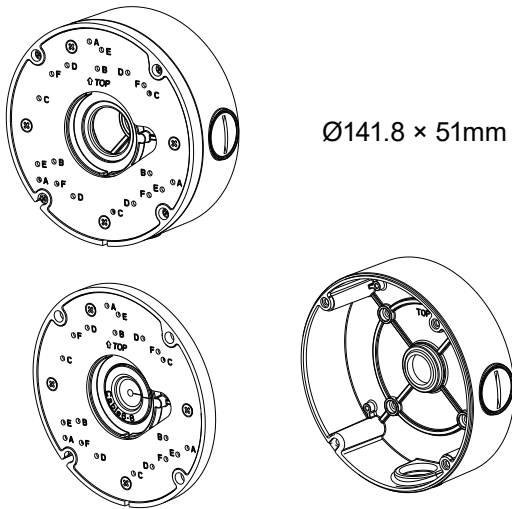

**Package Contents**

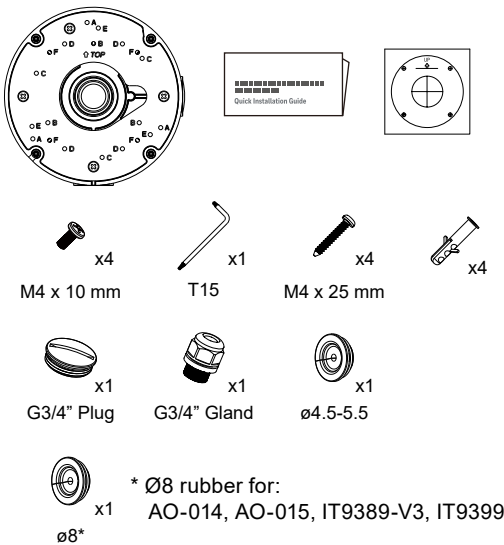

**3** Attach the included alignment sticker to a preferred position. Drill holes on the wall and install the junction box. If space behind the wall allows, you may also pass cables through the wall.

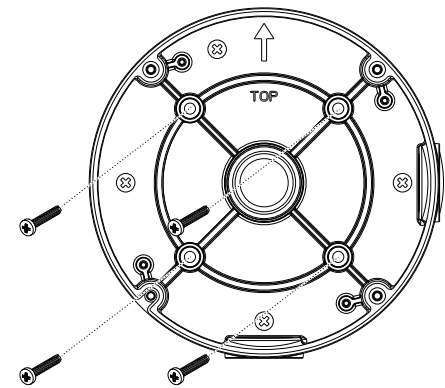

**4** Pass the camera's Ethernet cable through the center hole of the box and the rubber seal.

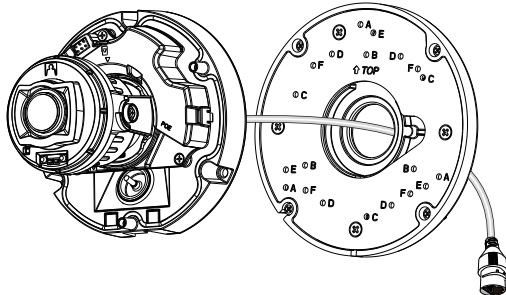

**5** Install the waterproof components of the cable gland to your Ethernet cable following the QIG of your camera. The cable gland will be placed within the protection of the box.

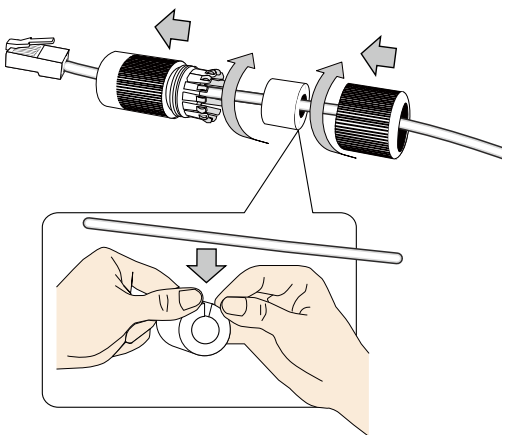

**6** Make sure the rubber seal is properly installed to the center hole. The outer rim of the seal must be through and cover the edge of the hole.  
Choose the appropriate rubber seal: Ø8 x1 based on diameter of your cable, Ø4.5-5.5 x1

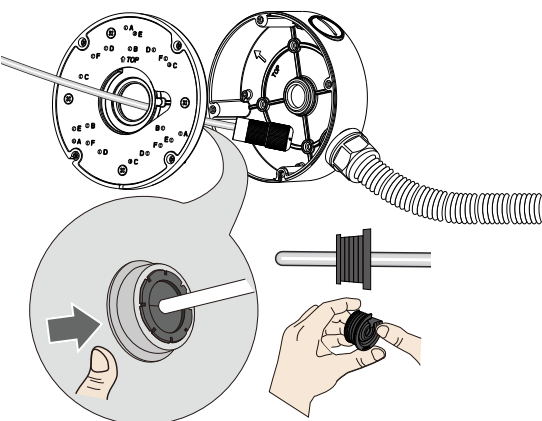

**Installation – Dome Camera Type**

**1** Remove the top cover.

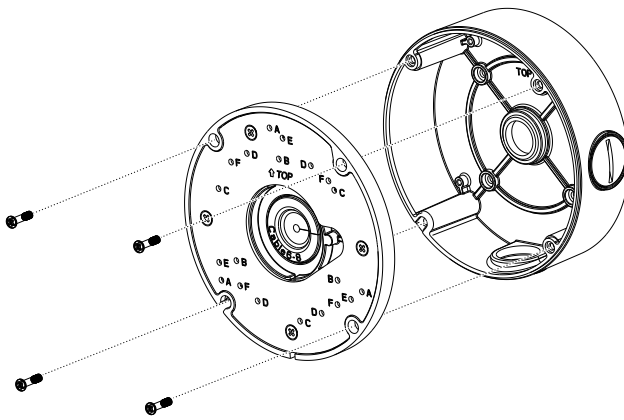

**2** A 3/4" conduit is required for routing the cables with waterproof connection.

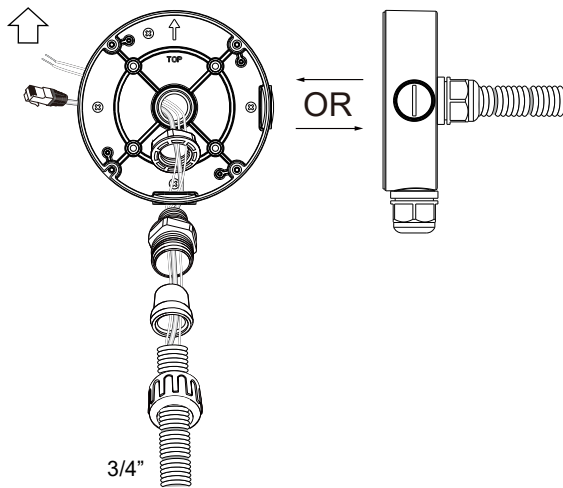
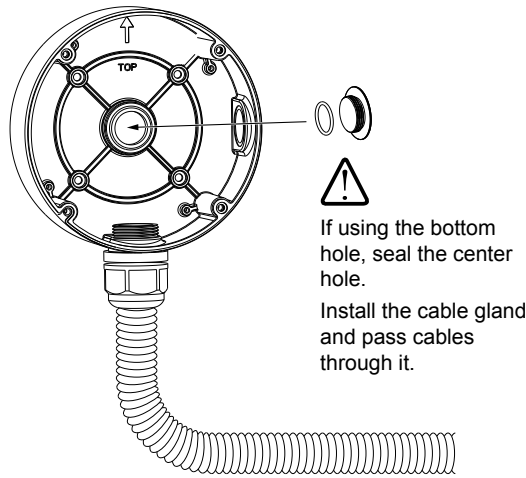

**7** A. FD9368/FD9383-HTV/FD9388/FD9389-V2/FD9389-V3/FD9399  
B. IT9383/IT9388  
C. FD9360/FD9380/FD9383-HV  
D. IT9389-V3/IT9399/FE9380/FE9382-V2/FE9391-V2/FE9191-V2  
E. TB9332-E  
F. TB9333-E/TT9333-E

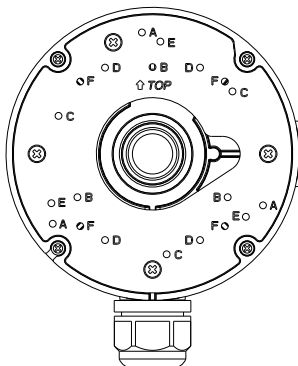

**8** Secure the top cover by fastening 4 screws.

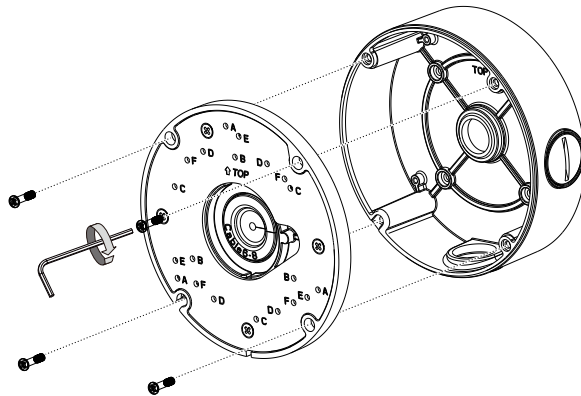

**9** Secure the top cover by fastening the corresponding mounting holes.

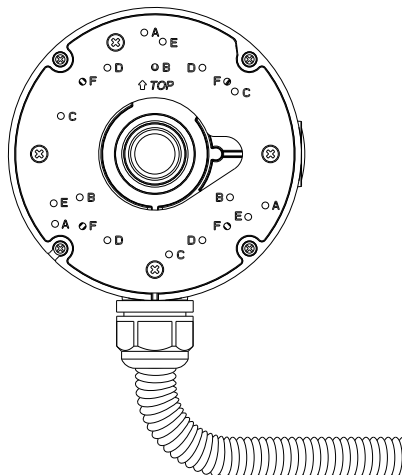

**10** Install the camera using the corresponding mounting holes

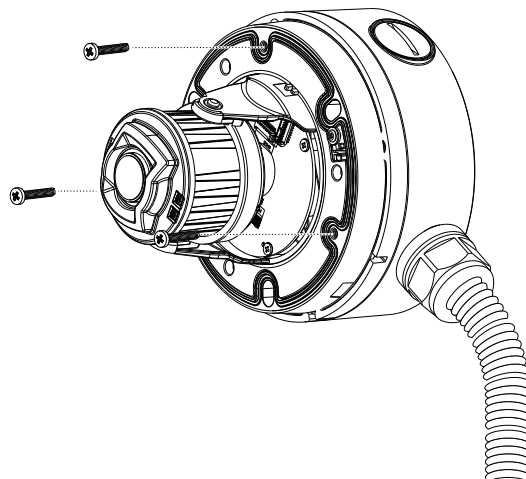

**11** Open a live view console and adjust the shooting direction. Refer to camera QIG for more information. Secure the camera top cover

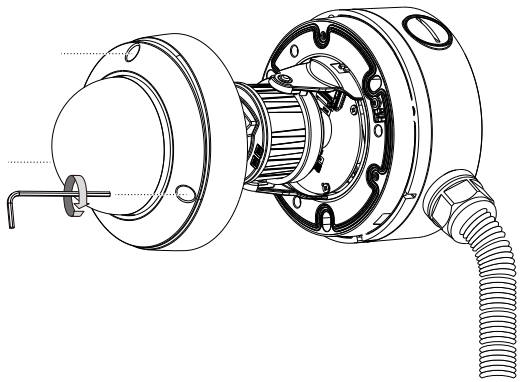

### III Installation – Turret Camera Type

**1**

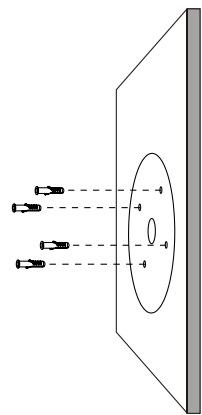

**2**

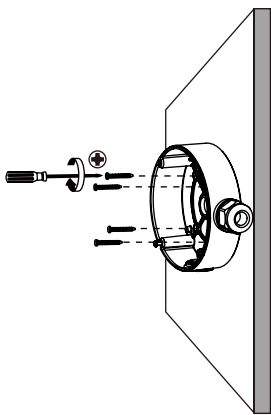

**3**

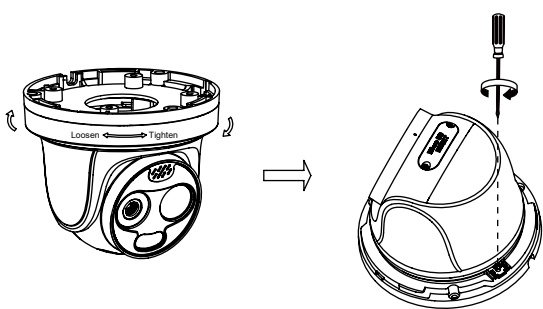

**4**

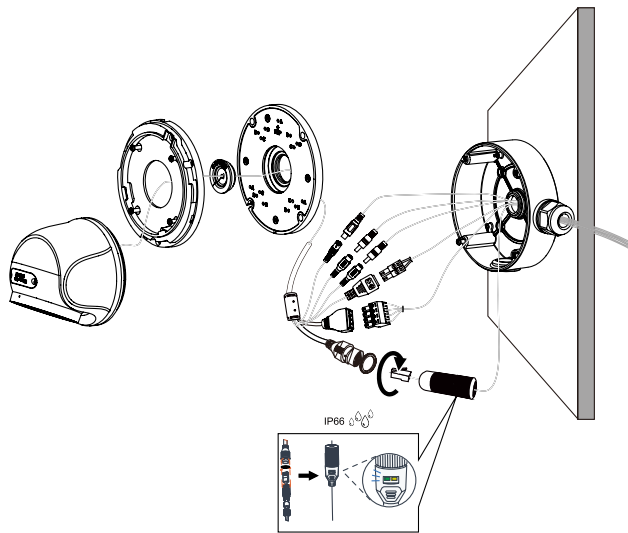

**5**

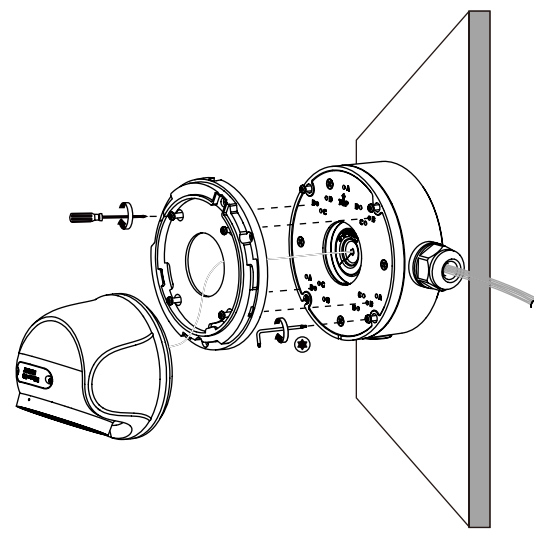

**6**

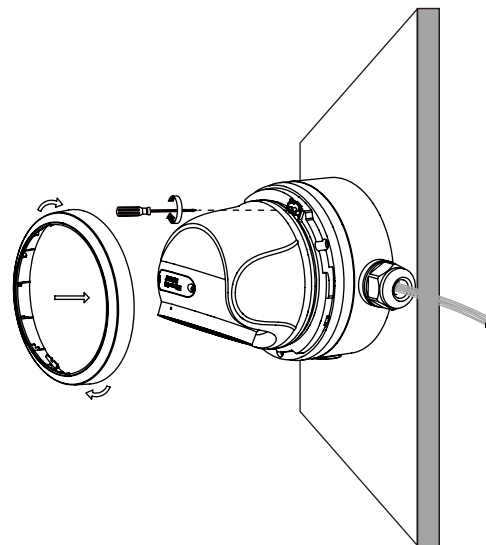

**7**

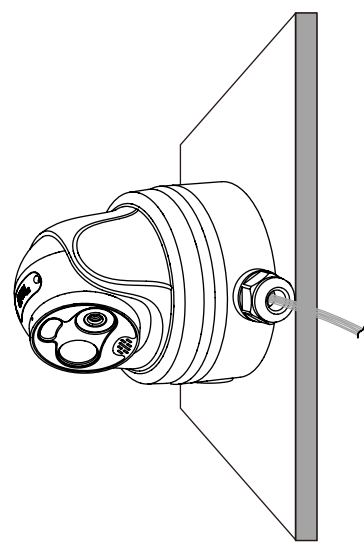

### IV Installation – Reference Pictures

FD9383-HV, FD9360, FD9380

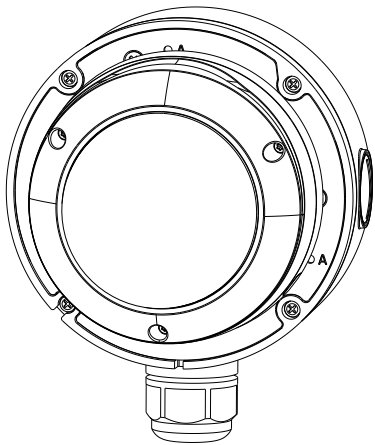

FD9389-V3, FD9399

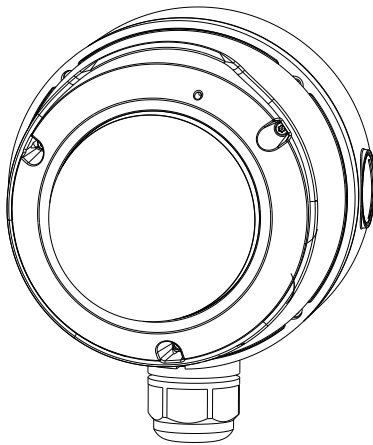

IT9389-V3, IT9399

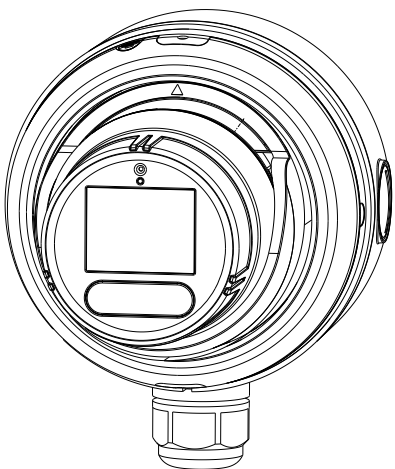

FE9380, FE9382-V2, FE9391-V2, FE9191-V2

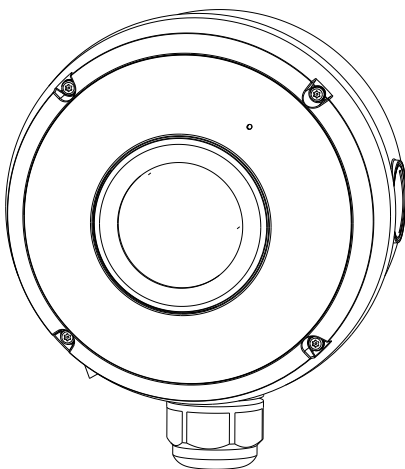

Please contact authorized distributors for warranty and RMA service.  
Visit <https://www.vivotek.com/support/warranty> and <https://www.vivotek.com/support/rma>